

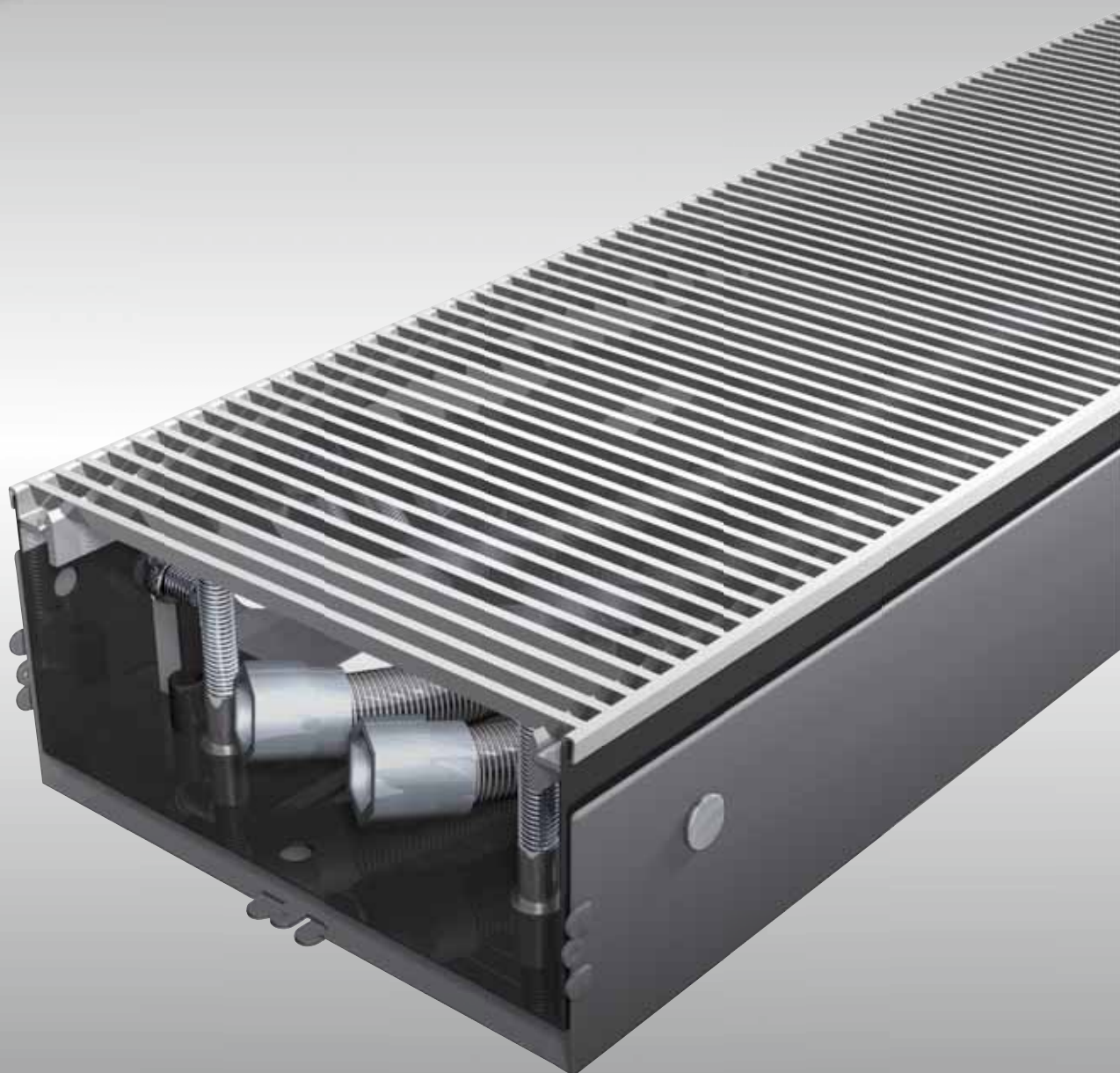

**jaga**



TOP  
PERFORMERS

**MICRO CANAL**

2018.EX



# MICRO CANAL

Maximum warmth, minimum dimensions

The latest Jaga trench heating solution is only 6 cm high and 14 cm wide. With small, but powerful dynamic Low-H<sub>2</sub>O heat exchangers and super-quiet fans that are no wider than a thermostatic radiator valve, it creates immense power. Micro Canal combines minimalist aesthetics and architectural freedom with a power that breaks all temperature records! Micro Canal integrates harmoniously with any interior. This provides every architect, designer or engineer the greatest possible design freedom on any project without making any compromises for the heating system.

By using **the latest EC motors**, Micro Canals consume up to 50% less electricity than traditional motors



TOP  
PERFOR  
MERS

MICRO CANAL





# MICRO CANAL



## DIMENSIONS (in cm)

### Inner casing

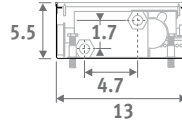
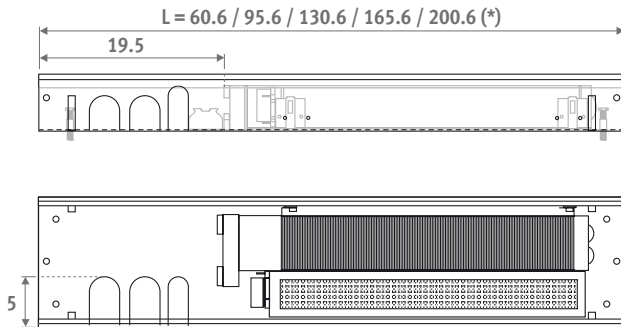

(\*) In case of through-mounting, do not install the intermediate tops. Reduce length by 3 mm for each top.

### Outer casing

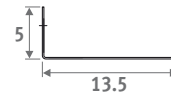
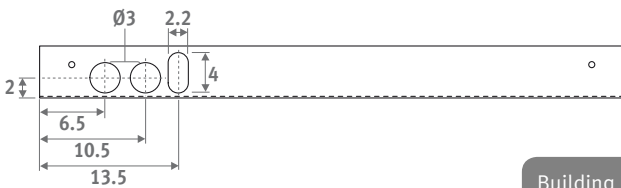

Building in-opening: +0.5 cm

## ORDERING CODE

code

**EPMicro Lxxx**

## STANDARD DELIVERY

- stainless steel grille
- outer casing with anchorage elements
- polyethylene-protective mounting block(s) and three connection holes on the left hand side
- pre-assembled internal duct with stainless steel grille support
- tangential activator(s) 24 VDC and integrated stainless steel filter
- dynamic heat exchanger with flexible 1/2" stainless steel connectors, length 15 cm
- height adjustment with fine adjustment for alignment with the finished floor.
- automatic activator on/off switch by means of temperature sensor, at 34°C

With energy efficient EC motor

## HYDRAULIC CONNECTION

- one-sided 2-pipe connection on the left
- always install Micro Canal with the heat exchanger on the window or wall side
- 2 x 1/2" stainless steel hose included
- allow extra space for curtains, in between the window and the Micro Canal.
- The heat exchanger must always be kept accessible for maintenance purposes
- if the appliance is not mounted flat on the floor, the space between the bottom of the appliance and the floor should be filled with a stable filler material.

## ELECTRIC CONNECTION

- clamp connector for electrical connection 24 VDC to the left, to be connected via external power supply. Install a thermostat with a potential-free contact to control the water supply with the help of a zone valve. Micro Canal automatically switches on the activators via a temperature sensor.

## COMPOSITION

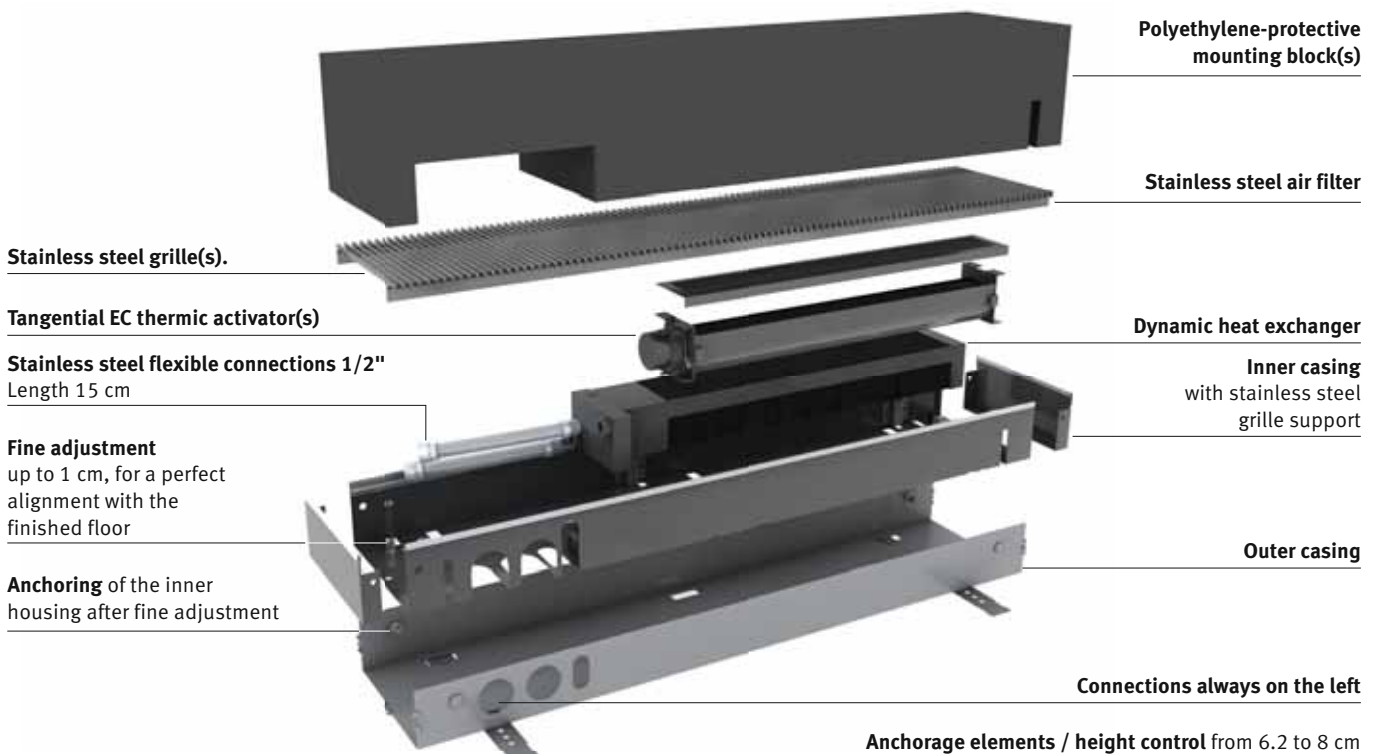

# MICRO CANAL



H L B	HEATING			ACTI-VATORS	SOUND PRESSURE*	POWER CON-SUMPTION	AIR FLOW	WATER FLOW
	Watts	Watts	Watts	quantity	dB(A)	Watts	with clean filters	
	75/65/20°C	55/45/20°C	35/30/20°C				m³/h	litre/h
006	390	234	98	1	18.0	1.6	29.3	34
060	780	468	195	1	21.0	1.9	58.5	67
14	1170	702	293	1	22.8	2.2	88.0	101
095	1560	936	390	2	24.0	3.1	117.0	134
130	1950	1170	488	2	25.0	3.5	146.5	168
165								
200								

\* With an assumed room attenuation of 8 dB(A) / content of the room 75 m³ / reverberation time 0.5 sec. / measured at 1 m height and 2 m from the appliance.  
Correction factors & pressure drop: see "Technical info" chapter

## RECOMMENDED COMBINATIONS

	Heating
Product	Micro Canal
Power supply	Power supply: ordering code 37603.010002
Connection set	Connection set 92 with 2 lockshields CODY.LOA.00.3,.. <i>(fill in sleeve coupling code: see p. 312)</i>

## OVERVIEW GRILLES

### Stainless steel grilles



SSS  
stainless steel

### Stainless steel grilles lacquered

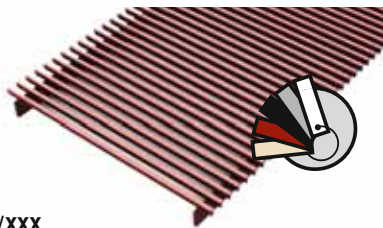

SSC/XXX  
stainless steel lacquered

To ensure perfect adherence of the lacquer coating, an extremely wear-resistant and UV-resistant polyester lacquer coating of the highest quality is used. Only in glossy (code 2..) and special colours 006, 005, 026, 028.

## STANDARD DELIVERY

### ASSEMBLY & PROTECTION BLOCK

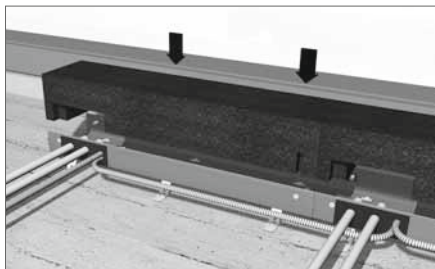

Install the polyethylene protective block(s) as protection on the construction site.

### DESIGN GRILLES

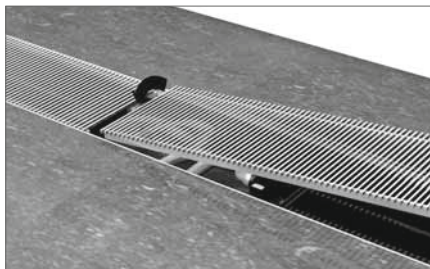

Continuous design grille of stainless steel grilles.

### HEIGHT CONTROL



Double height adjustment by means of the anchoring on the outer casing and by fine adjustment with the bolts in the inner housing (adjustable from 6.2 to 8 cm).

### FLEXIBLE CONNECTION

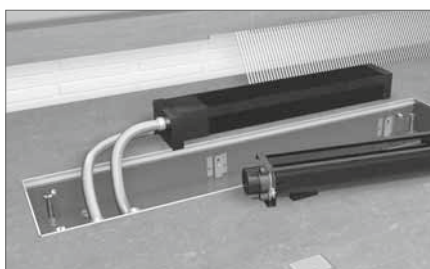

Stainless steel flexible hoses (15 to 25 cm), enabling the internal mechanism to be removed completely for easy cleaning.

# MICRO CANAL - OPTIONS

## POWER SUPPLY DIN-RAIL MONTAGE



The guarantee is only valid if the original Jaga power supply is used.

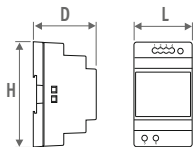

CODE	H	L	D
7990.054	9.0	3.5	5.9
7990.055	9.0	5.3	5.9
7990.056	9.0	7.0	5.9
7990.053	12.5	12.6	8.3

- for DIN-rail or wall mounting
- conformity UL60950 / UL508 / IEC 60950-1 / TUV EN61558-2-16 / Class 2
- output voltage 24 VDC
- input voltage 100 - 240 VAC
- screw connection
- LED indicator

CODE	Output Watts	Output current A
7990.054	36	1.5
7990.055	60	2.5
7990.056	100	3.9
7990.053	240	10

*Required power = sum of the power consumption of the devices*

## MAXIMUM CABLE LENGTH

In function of the number of devices: see <http://www.jaga.be/en/products/trench-heating/micro-canal>

## SEPARATE POWER SUPPLY

Waterproof power supply 24 VDC/30 Watt with waterproof cable gland.



Not suitable for installation in the floor duct.

- conformity: UL60950 - EN 60950 / Class 2
- output voltage 24 VDC
- input voltage 100 - 240 VAC
- dimensions L 14.5 x B 4.5 x H 3.0 cm

CODE	Output Watts	Output current A
37603.010002	30	1.25

# MICRO CANAL - OPTIONS



## EMPTY HOUSING

To fill open spaces for a continuous installation.



- outer casing with height control
- inner casing with stainless steel grille support
- stainless steel grille, natural coloured or lacquered
- protection block(s)
- 2 head pieces

### empty housing with stainless steel grille

CODE	L
7522.00603514/SSS	35
7522.00606014/SSS	60
7522.00609514/SSS	95
7522.00613014/SSS	130
7522.00616514/SSS	165
7522.00620014/SSS	200

### empty housing with lacquered stainless steel grille

CODE	L
7522.00603514/SSC/ ...	35
7522.00606014/SSC/ ...	60
7522.00609514/SSC/ ...	95
7522.00613014/SSC/ ...	130
7522.00616514/SSC/ ...	165
7522.00620014/SSC/ ...	200

enter colour code

## CORNER PIECE



- aluminium cover plate in stainless steel effect (SSS), or lacquered in other Jaga colours (SSC)
- outer casing with anchorage elements
- polyethylene-protective mounting block(s)
- fully assembled inner housing with stainless steel grille support
- height adjustment with fine adjustment for alignment with the finished floor

### Outer corner

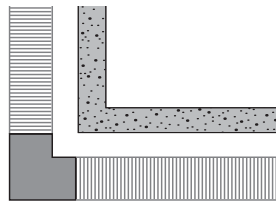

#### CODE

7522.00602014/SSS/02 Natural  
7522.00602014/SSC/.../02 lacquered

enter colour code

### Inner corner

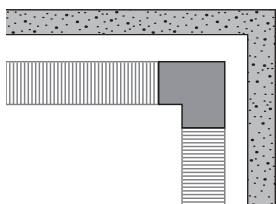

#### CODE

7522.00602014/SSS/01 Natural  
7522.00602014/SSC/.../01 lacquered

enter colour code

## FEET WITH HEIGHT ADJUSTMENT FOR RAISED FLOORS

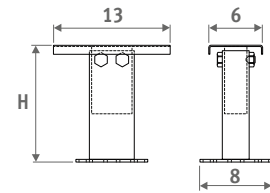

- lacquered in dark grey RAL 7024.
- easy installation by means of "stainless steel spring system"
- 1 set includes 2 height adjusting controls

### Number of sets per Micro Canal

L 35 = 1 set
L 60 = 1 set
L 95 = 1 set
L 130 = 2 sets
L 165 = 2 sets
L 200 = 2 sets

CODE	H
5207.05070000	5 > 7 cm
5207.08130000	8 > 13 cm
5207.13230000	13 > 23 cm
5207.20300000	20 > 30 cm

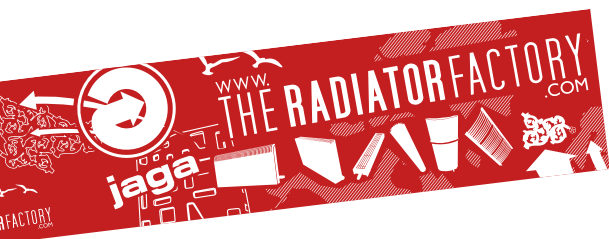

Jaga International  
Verbindingslaan 16  
B-3590 Diepenbeek

Tel.: +32 (0)11 29 41 12  
Fax: +32 (0)11 29 41 60  
export@jaga.be

The information in this price list is correct at the time of printing.  
Jaga reserves the right to change product specification at any time in line  
with our policy of continuous improvement and innovation.  
All prices in Euro, exclude VAT. Prices valid from 1st March 2018.  
Replaces all existing price lists.